

## Dual Switching Diode

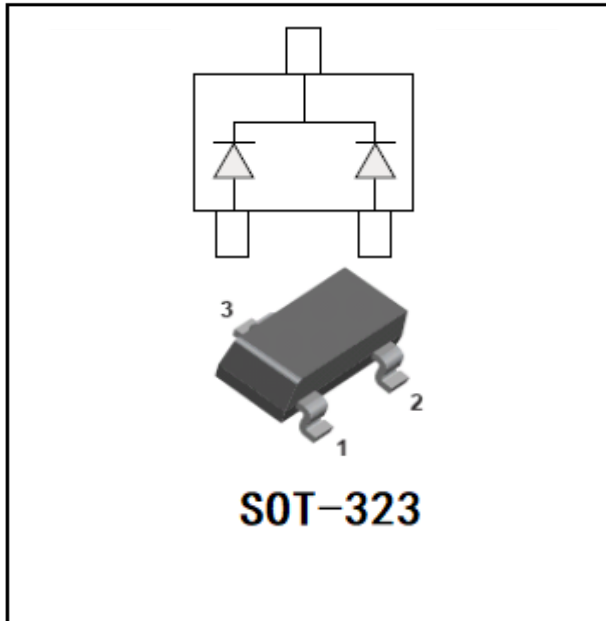

### Features

- Epoxy meets UL-94 V-0 flammability rating
- Fast switching speed
- High Conductance
- Surface mount package ideally Suited for Automatic Insertion

### Mechanical Data

- **Package:** SOT-323
- **Terminals:** Tin plated leads, solderable per J-STD-002 and JESD22-B102
- **Marking:** N

### ■ Maximum Rating, ( $T_a=25^{\circ}\text{C}$ Unless otherwise specified)

Item	Symbol	Unit	Value
Peak Reverse Voltage	$V_{RRM}$	V	80
Reverse Voltage	$V_R$	V	80
Forward Continuous Current	$I_F$	mA	100
Non-repetitive Peak Forward Surge Current @ $t_p=1\mu\text{s}$	$I_{FSM}$	A	4
Power Dissipation	$P_D$	mW	200
Maximum junction temperature	$T_J$	$^{\circ}\text{C}$	150
Storage Temperature	$T_{STG}$	$^{\circ}\text{C}$	-55 to +150

### ■ Ordering Information (Example)

PREFERRED P/N	PACKING CODE	UNIT WEIGHT(g)	MINIMUM PACKAGE(pcs)	INNER BOX QUANTITY(pcs)	OUTER CARTON QUANTITY(pcs)	DELIVERY MODE
DAN202U	F2	Approximate 0.005	3000	30000	120000	7" reel



# DAN202U

## ■ Electrical Characteristics (T<sub>a</sub>=25°C Unless otherwise specified, Per Leg)

Item	Symbol	Unit	Conditions	Value
Minimum Reverse Voltage	V <sub>R</sub>	V	I <sub>R</sub> =100uA	80
Maximum Instantaneous Forward Voltage	V <sub>F</sub>	V	I <sub>F</sub> =100mA	1.2
Maximum DC Reverse Current	I <sub>R</sub>	uA	V <sub>R</sub> =70V	0.1
Typical Junction Capacitance	C <sub>J</sub>	pF	f=1.0MHz, V <sub>R</sub> =6V	4
Maximum Reverse Recovery Time	T <sub>rr</sub>	ns	I <sub>F</sub> = I <sub>R</sub> =10mA, R <sub>L</sub> =100Ω, I <sub>rr</sub> =0.1* I <sub>R</sub>	4

## ■ Typical Characteristics

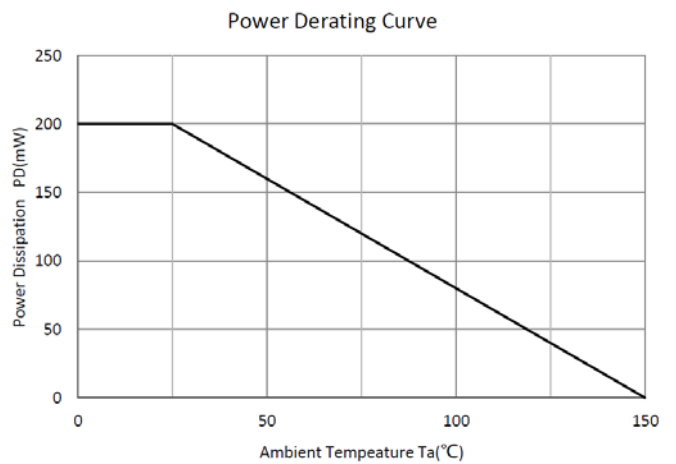
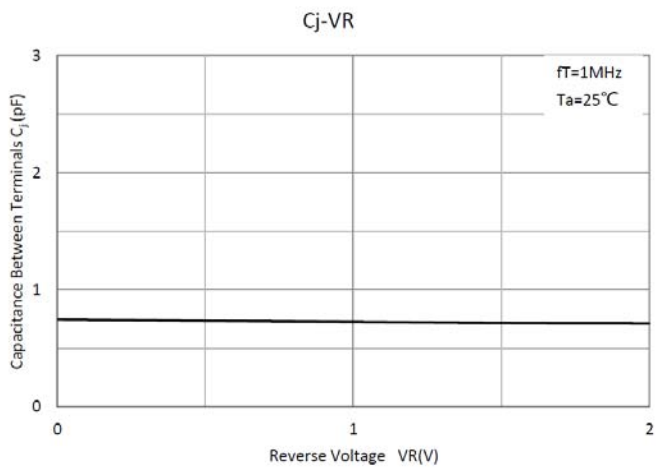
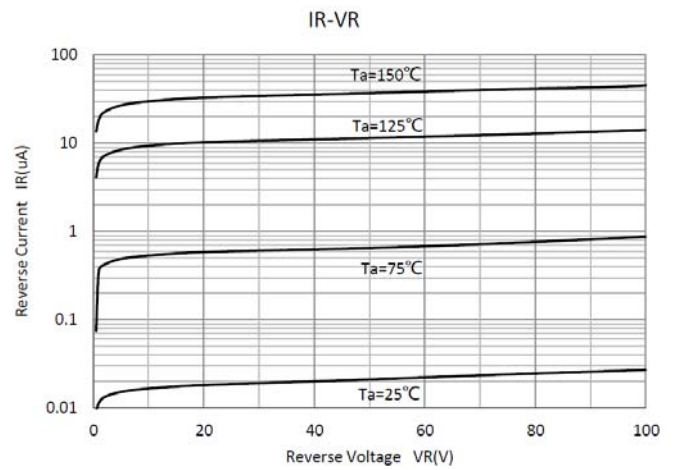
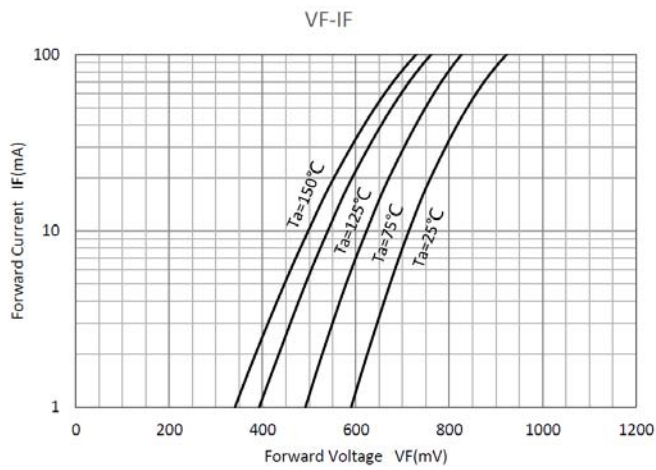

Surge Forward Current Capability

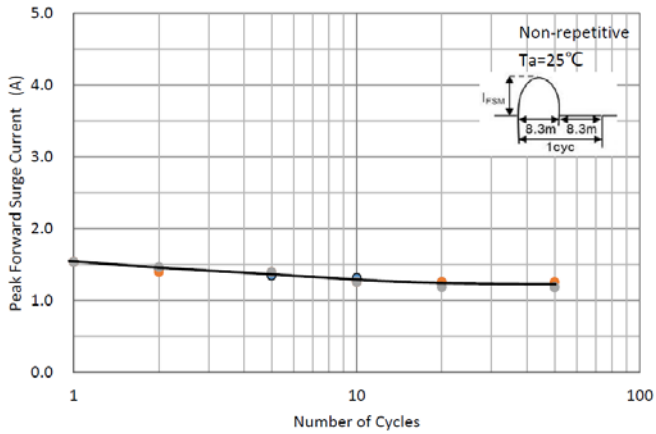

IFSM-tp

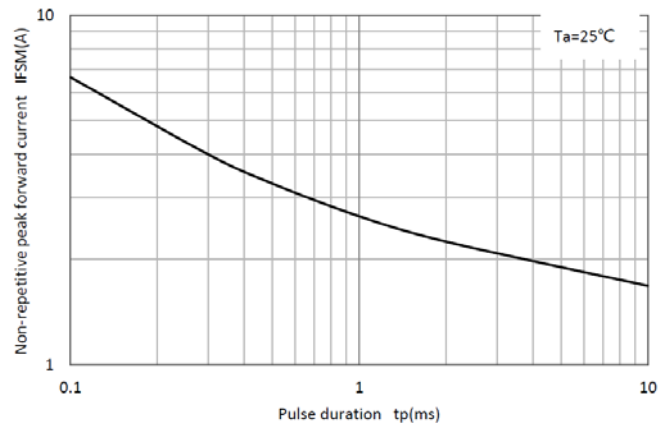

## ■ SOT-323 Package Outline Dimensions

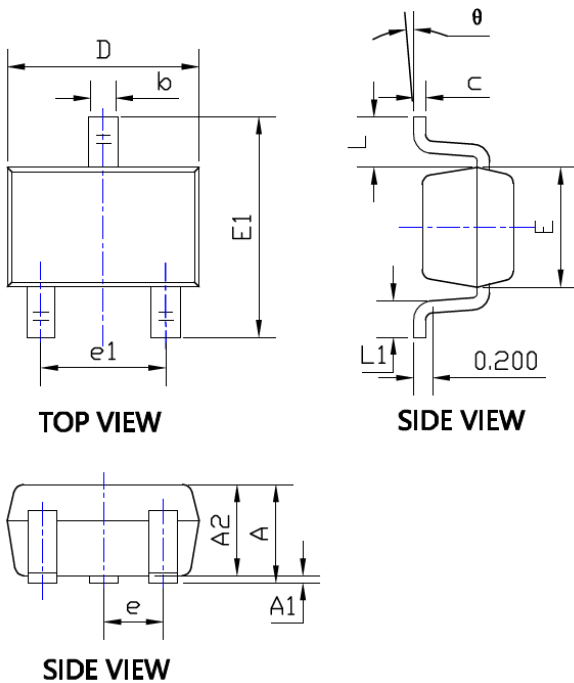

SYMBOL	DIMENSIONS			
	INCHES		Millimeter	
	MIN.	MAX.	MIN.	MAX.
A	0.035	0.043	0.900	1.100
A1	0.000	0.004	0.000	0.100
A2	0.035	0.039	0.900	1.000
b	0.006	0.016	0.150	0.400
c	0.004	0.010	0.100	0.250
D	0.071	0.087	1.800	2.200
E	0.045	0.053	1.150	1.350
E1	0.085	0.096	2.150	2.450
e	0.026 TYP		0.650 TYP	
e1	0.047	0.055	1.200	1.400
L	0.021 REF		0.525 REF	
L1	0.010	0.018	0.260	0.460
θ	0°	8°	0°	8°

## ■ SOT-323 Soldering Footprint

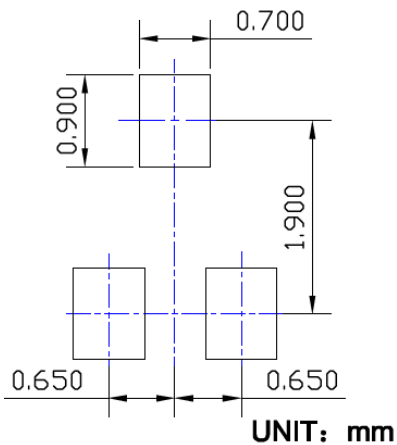



## Disclaimer

The information presented in this document is for reference only. Yangzhou Yangjie Electronic Technology Co., Ltd. reserves the right to make changes without notice for the specification of the products displayed herein to improve reliability, function or design or otherwise.

The product listed herein is designed to be used with ordinary electronic equipment or devices, and not designed to be used with equipment or devices which require high level of reliability and the malfunction of which would directly endanger human life (such as medical instruments, transportation equipment, aerospace machinery, nuclear-reactor controllers, fuel controllers and other safety devices), Yangjie or anyone on its behalf, assumes no responsibility or liability for any damages resulting from such improper use of sale.

This publication supersedes & replaces all information previously supplied. For additional information, please visit our website [http:// www.21yangjie.com](http://www.21yangjie.com) , or consult your nearest Yangjie's sales office for further assistance.